

CKRV01N-WEB - Rover K - SF48 Taper Kit

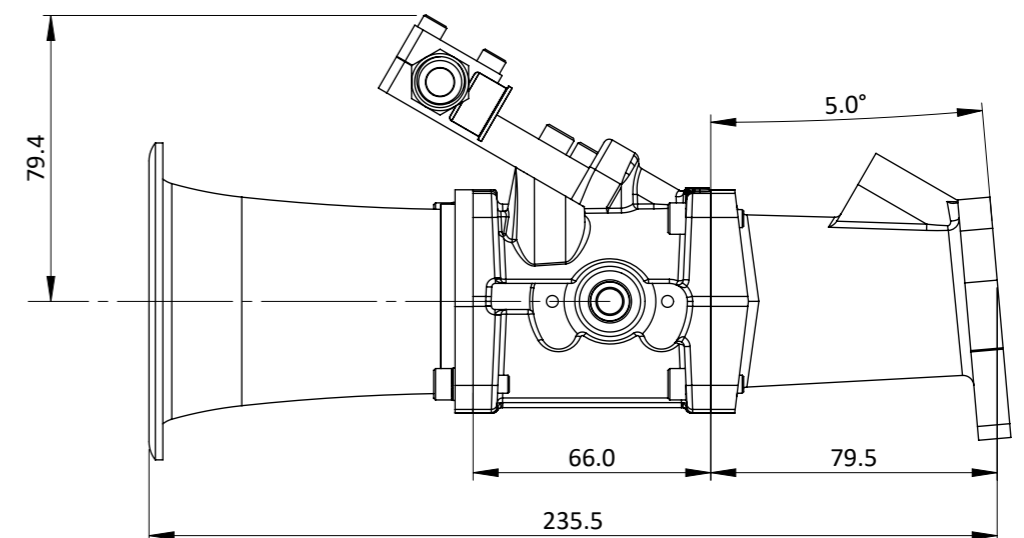

Engineered to win

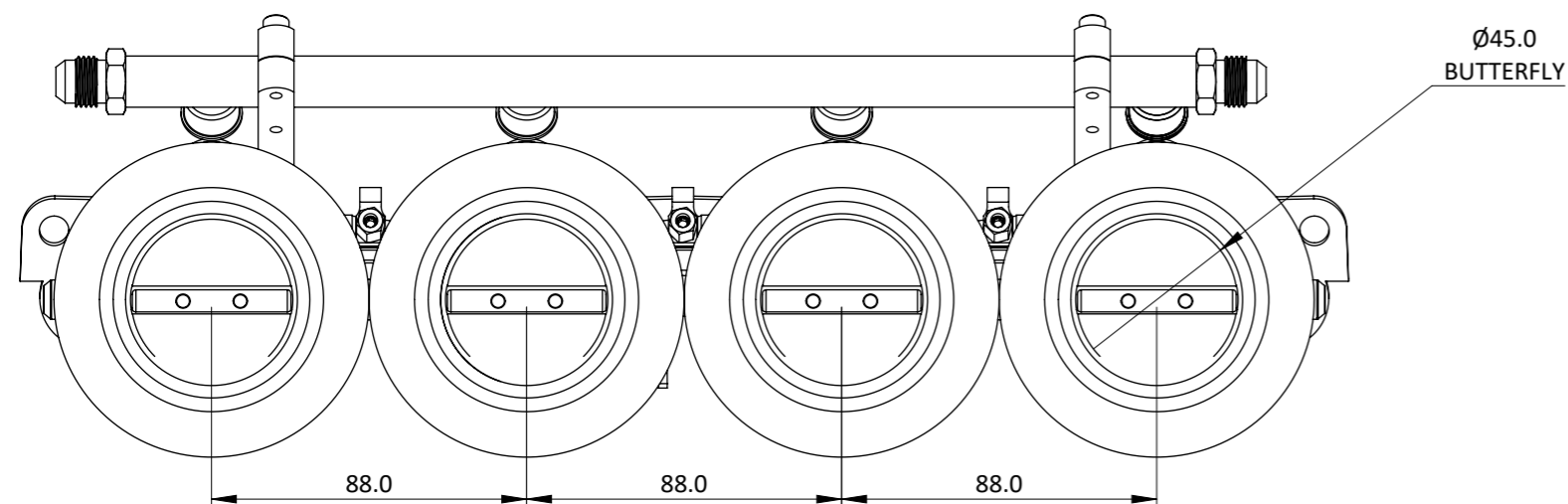
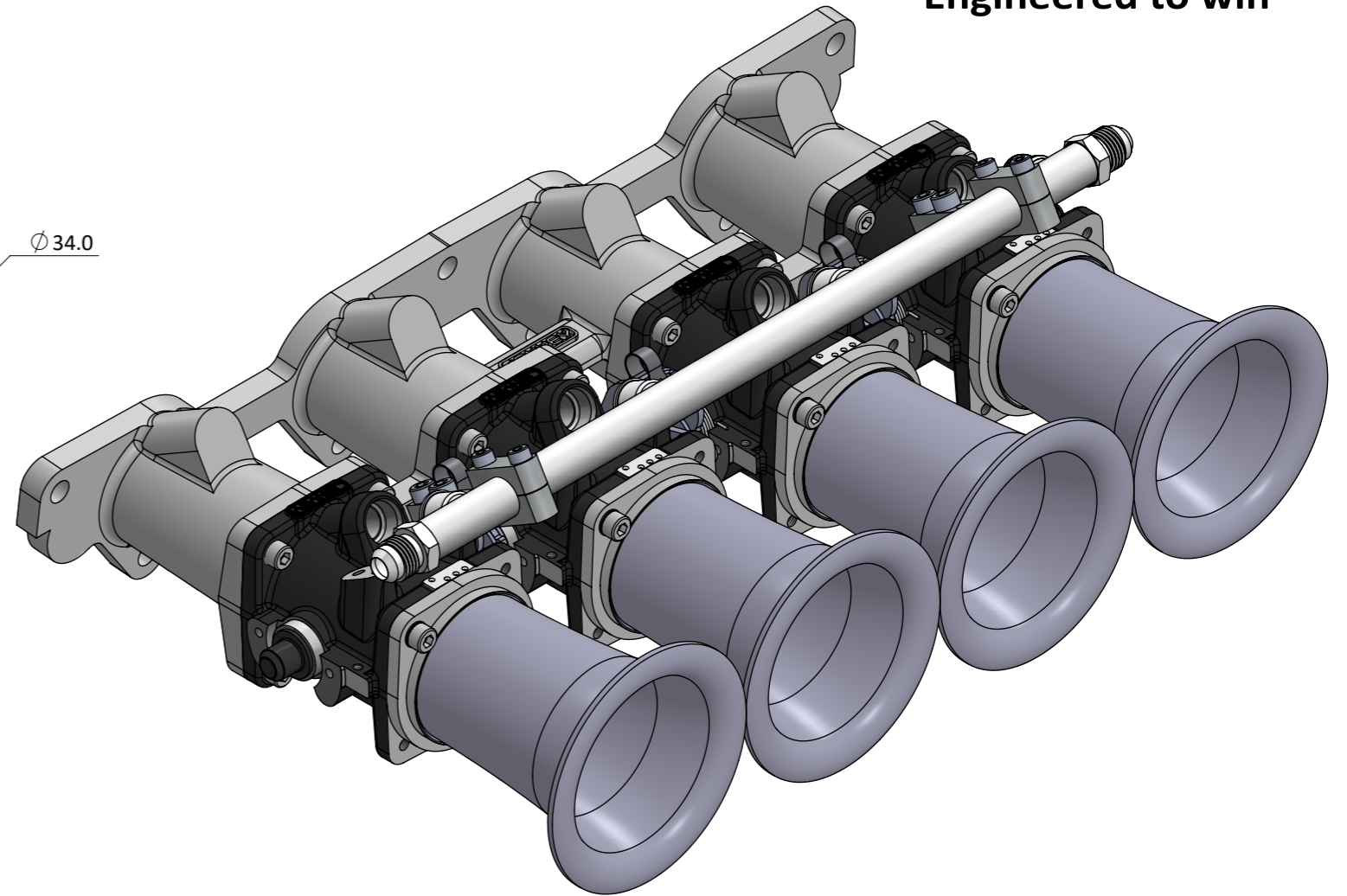
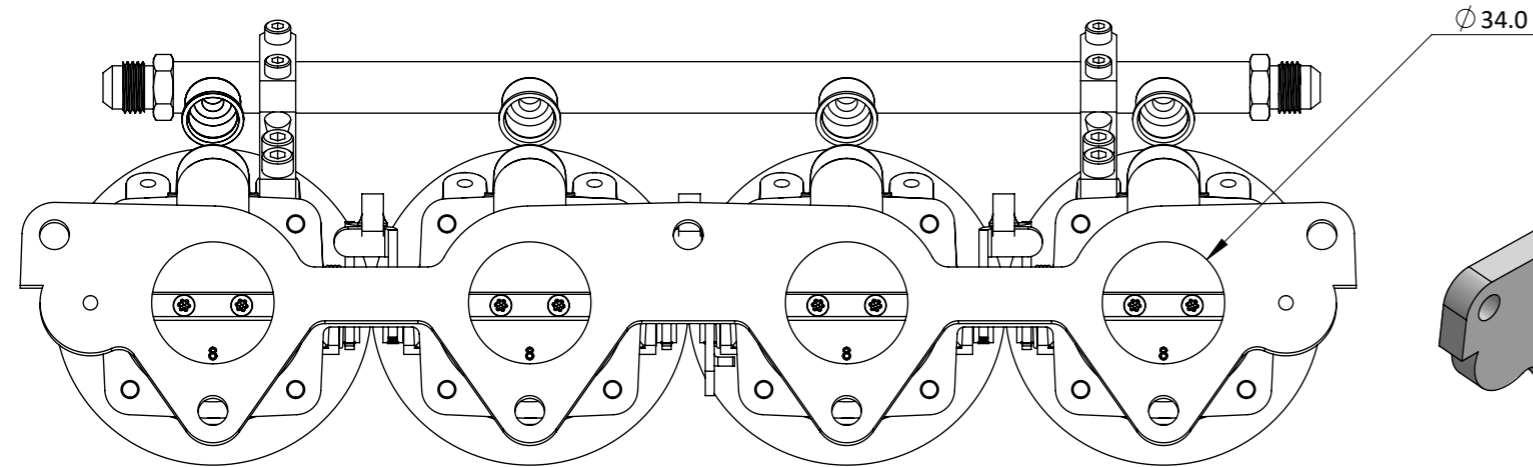

The Rover K Individual Throttle Body (ITB) kit for fuel injecting your Rover K series engine which contains an inlet manifold, four 48mm tapered SF throttle bodies (45mm butterfly), fuel rail, fuel rail mounts and 90mm long airhorns.

This engine was used in Rover Metro, 200, MGF Lotus Elise, Caterham and many kit cars.

Frame: 1 of 1

Version: 1

Tel 01746 768810

© JENVEY DYNAMICS LTD. 2024

Web WWW.JENVEY.CO.UK

