

CKPE03 - Porsche 3 Stud - SF51 Taper Kit 46IN xxOUT

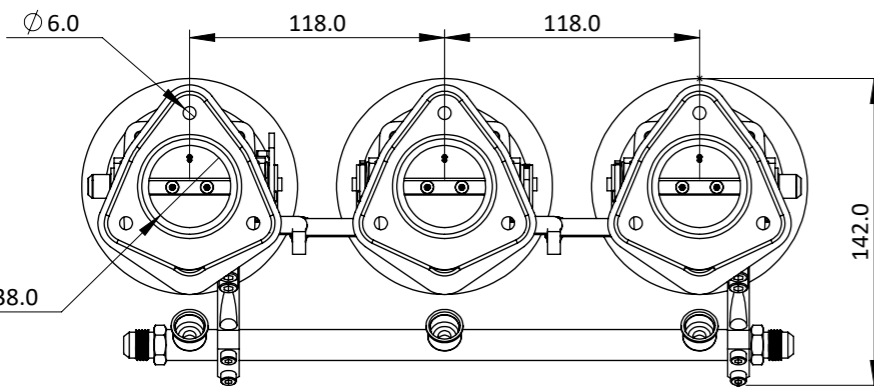

Engineered to win

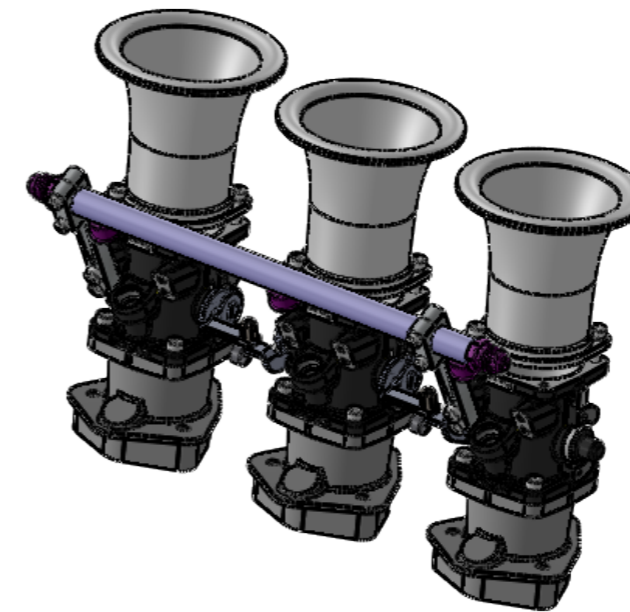
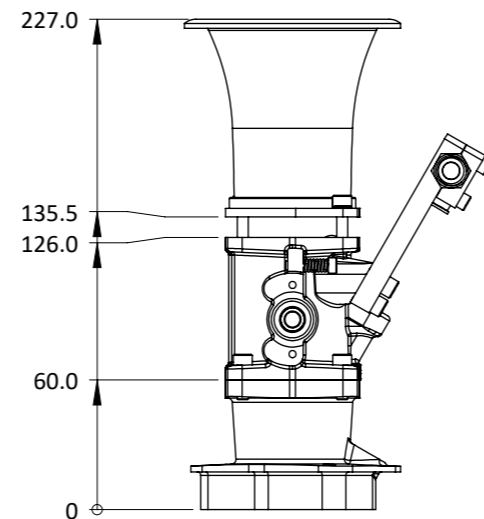
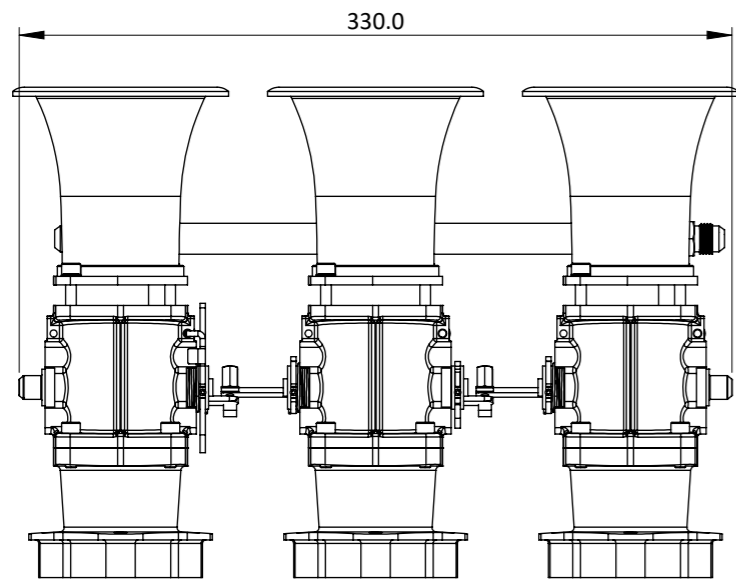
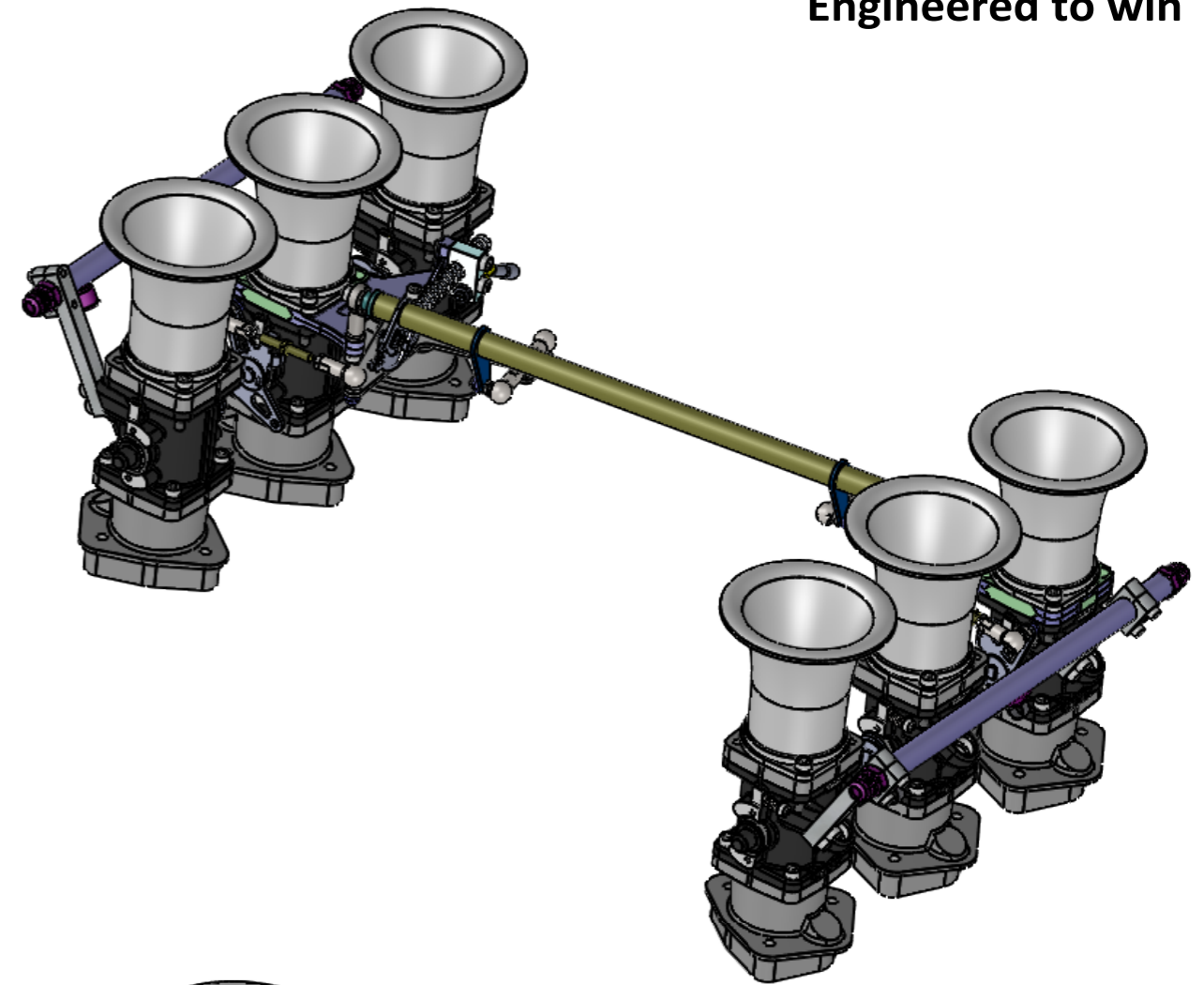
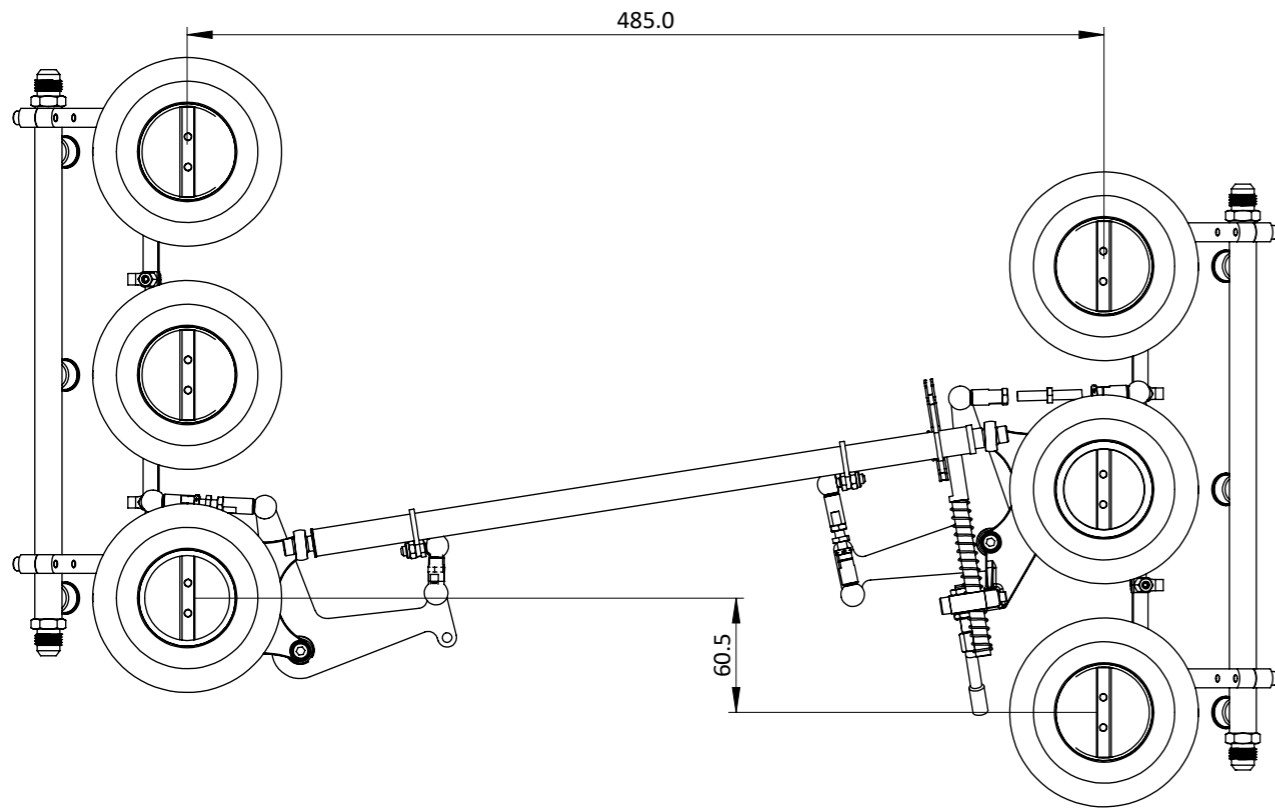

Porsche individual throttle body (itb) kit for fuel injecting your aircooled Porsche engine as used in 964 style cars. The kit contains inlet manifolds, SF51 taper throttle bodies (48mm butterfly), linkage kit, fuel rail, fuel rail mounts and a set of tapered airhorns. This kit is for the 3.6 and 3.8 litre 964 cars. Made to order.

May be ported out to 52mm at body flange and 48mm at head flange.

Supplied as set of 6.

Bosses on each port for injector pockets or vacuum tappings.

Frame: 1 of 1

Version: 1

Tel 01746 768810

© JENVEY DYNAMICS LTD. 2015

Web WWW.JENVEY.CO.UK

